

## Basic Troubleshooting

### \*LED not displayed

Check the power source is correct voltage (DC5V) and correct polarity.

### \*Display appears scrambled

Check that all connections are correct and tight.  
Check that there is no harsh interference nearby.

### \*Display 4 or -4

Please confirm signal input is a loop when it is voltmeter;  
Please confirm inputting signal is not more than its measuring range.

### \*A/D chip maybe murdered

Reading data isn't Zero when shorting voltmeter signal inputting terminals.  
Reading data isn't Zero when ammeter signal inputting is off.

## Panel Cutout:

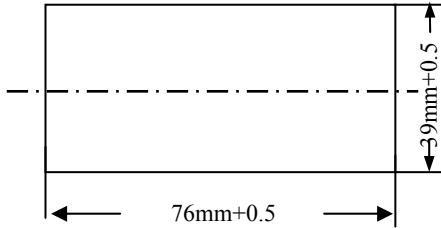

## XL34LCD Series Digital Panel Meter

# MANUAL

## XIELI

### ISO9001-2008 & CE

**Shaanxi XIELI Photo Electric Instrument Co., Ltd**

Add: No.2 Xinke Rd, Eastern Development Zone,

Xi'an 710043, Shaanxi, CHINA

Tel: +86-29-82622375 Fax: +86-29-84023638

Website: [www.xieli-china.com](http://www.xieli-china.com)

## XL34LCD Series Digital Voltmeter

### Power supply DC5V measuring DC voltage/Current

#### OPERATION SPECIFICATIONS:

Power Supply	DC5V±10% (30mA)
Maximum Count	3999(3 3/4 digit)
Display	LCD display
Operating temperature	0°C~60°C
Storage Temperature	-20°C~80°C
Relative humidity	20%~80%
Dimension	W79mm x H42.5mm x D55mm
Panel Cutout	76mm×39mm
Weight	45~50g
Sample Frequency	400ms
Auto Zero	
Polarity	Automatic Sensing
Data Holding	
Over Range	Display 4 or -4

Can be re-calibrated by adjusting the calibration potentiometer  
 Easy to install, snap-in/mount in panel  
 Ideal for auto, boat, industrial, commercial & domestic uses  
 Decimal Point position can be selected by user

#### WIRING DIAGRAM

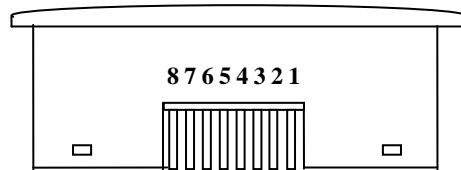

PIN 1	DC5V+ Power supply
PIN2	DC5V- Power supply
PIN 3	Backlighting Control by short PIN 1 & PIN3
PIN 4	Blank
PIN 5	Blank
PIN 6	Data Holding [Short PIN6 & PIN1]
*The data hold control cable must be less than 30cm.	
PIN 7	DC + voltage signal input
PIN 8	DC - voltage signal input

#### \*Decimal point adjustment:

\*\*First Open Meter Back Cover

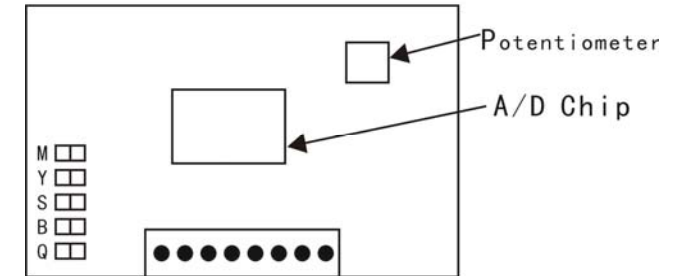

Please soldered M pad if you needn't to display decimal point.

Please soldered Y pad & Cut off M pad if you want display decimal point.

Short S by jumper, Decimal point will display 399.9

Short B by jumper, Decimal point will display 39.99

Short Q by jumper, Decimal point will display 3.999

#### LCD display DC Voltmeter

Model No.	Range	Resolution	Max. Input	Input Impedance
XL34LCDV-1	+399.9mV	0.1mV	±5V	100MΩ
XL34LCDV-2	+3.999 V	1mV	±35V	10MΩ
XL34LCDV-3	+39.99V	10mV	+250V	10MΩ
XL34LCDV-4	+3.99.9 V	100mV	+500V	10MΩ

#### LCD display DC Ammeter

Model No.	Range	Resolution	Max. Input	Input Impedance
XL34LCDA-1	± 399.9μA	100nA	± 15mA	1KΩ
XL34LCDA-2	± 3.999mA	1μA	± 50mA	100Ω
XL34LCDA-3	± 39.99mA	10μA	± 150mA	10Ω
XL34LCDA-4	± 399.9mA	100μA	± 500mA	1Ω