

Basic Troubleshooting

***LED not displayed**

Check that your power supply is correct voltage (DC5V) and correct polarity.
Check the connection of signals cable

***Display appears scrambled**

Check that all connections are correct and tight.
Check that there is no harsh interference nearby.

***0000 Displayed**

Voltage or current out of range. (protect mode)

***Others:**

The reading is not "0" when the input signal was shorted . The A/D chip was by breakdown sometimes

***Caution**

Do not disassemble
The polarity of power source prohibit reversed.

***Panel Cutout Size**

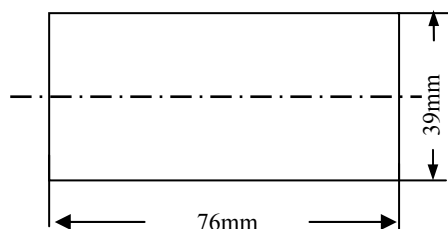

MANUAL

DIGITAL Voltmeter



Shaanxi XIELI Photo Electric Instrument Co., Ltd

Add: No.2 Xinke Rd, Eastern Development Zone,
Xi'an 710043, Shaanxi, CHINA
Tel: +86-29-82622375 Fax:+86-29-84023638
Email: info@xieli-china.com
<http://www.xieli-china.com>

**XL5145V (DC/DC)Series Digital Voltmeter
Power supply DC5V measuring DC voltage**

FEATURES:

- Power supply DC5V
- Ultra-bright LED display
- 15.00mm digital height
- Blue/Red/Green displays available
- Measured DC polarity: Automatic
- Auto zero reading for 0v input.
- Low cost high accuracy
- Can be re-calibrated by adjusting the calibration potentiometer
- Easy to install
- The location of the decimal point can be adjusted

OPERATION SPECIFICATIONS:

Power Supply	DC5V±10%
Power Consumption	150mA±2%
Maximum Count	19999
Operating temperature	0℃~60℃
Storage Temperature	-20℃~80℃
Relative humidity	20%~80%
Over Range Indication	0000 flash
Dimension	W79mm x H42.5mm x D25.5mm
Panel Cutout	76mm×39mm
Sample Frequency	400ms

CONNECTION DIAGRAM:

View of PINs with screen facing upwards.

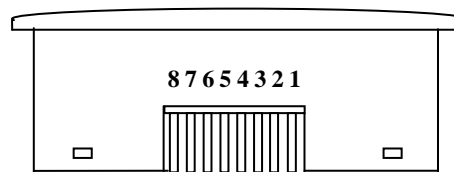

- PIN 1 DC + voltage signal input
- PIN 2 DC - voltage signal input
- PIN 3 DC5V- Power supply
- PIN 4 Data Hold [Short connection PIN3 & PIN4]
- *The data hold control cable must be less than 30cm.
- PIN 5 Decimal position 19.999[Short connection PIN3 & PIN5]
- PIN 6 Decimal position 199.99[Short connection PIN3 & PIN5]
- PIN 7 Decimal position 1999.9[Short connection PIN3 & PIN7]
- PIN 8 DC5V+ Power supply

Model	Range	Resolution	Input Impedance	Max Voltage Input	Accuracy
XL5145V-1	±199.99mV	0.01mV	100MΩ	±5V	±0.05%+3digit
XL5145V-2	±1.9999V	0.1mV	100MΩ	±30V	±0.05%+3digit
XL5145V-3	±19.999V	1mV	4.5MΩ	±250V	±0.05%+3digit
XL5145V-4	±199.99V	10mV	4.5MΩ	±500V	±0.07%+3digit
XL5145V-5	±500V	100mV	4.5MΩ	±600V	±0.7%+3digit